

PROPOSED SITE DEVELOPMENT WETLAND OVERLAY MAP

34

PERMITTED PLANS

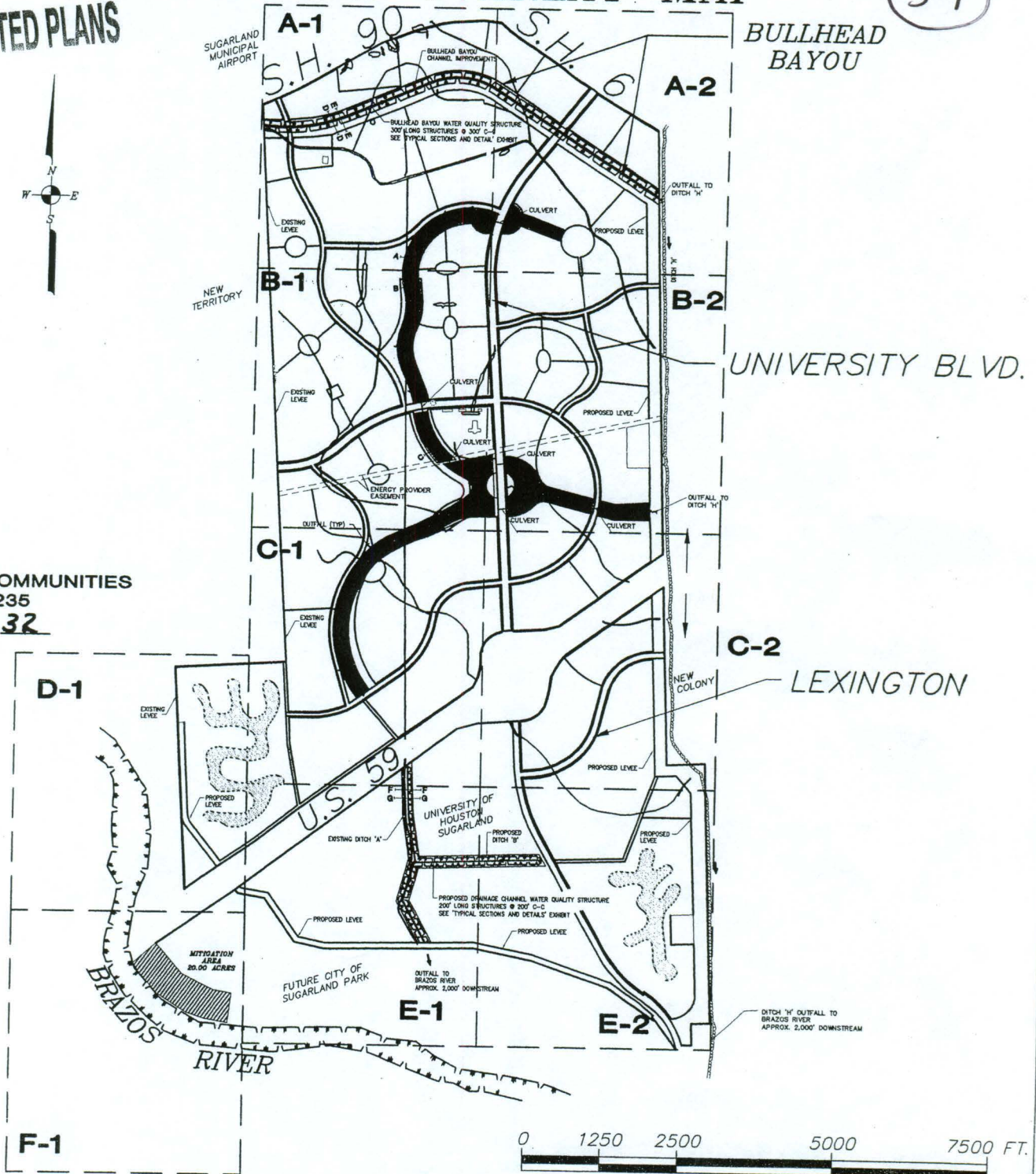
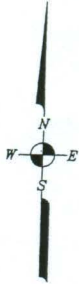

NEWLAND COMMUNITIES
PERMIT #23235
Sheet 1 of 32

PROPOSED SITE DEVELOPMENT WETLAND OVERLAY MAP

PROJECT #: 4170PM03
FOR: NEWLAND COMMUNITIES
LOCATION: 2018 ACRES - S.H. 6 & S.H. 90
FORT BEND COUNTY, TEXAS

REVISIONS:

Oct. 28, 2003 by C. H. Andrews
Nov. 14, 2003 by C. H. Andrews
Dec. 4, 2003 by E. Boulet
March 15, 2004 by C. H. Andrews

BERG-OLIVER ASSOCIATES, INC.
ENVIRONMENTAL SCIENCE, ENGINEERING &
LAND USE CONSULTANTS

14701 ST. MARY'S LANE, SUITE 400 HOUSTON, TX 77079
PHONE (281) 589-0898 <http://www.bergoliver.com>



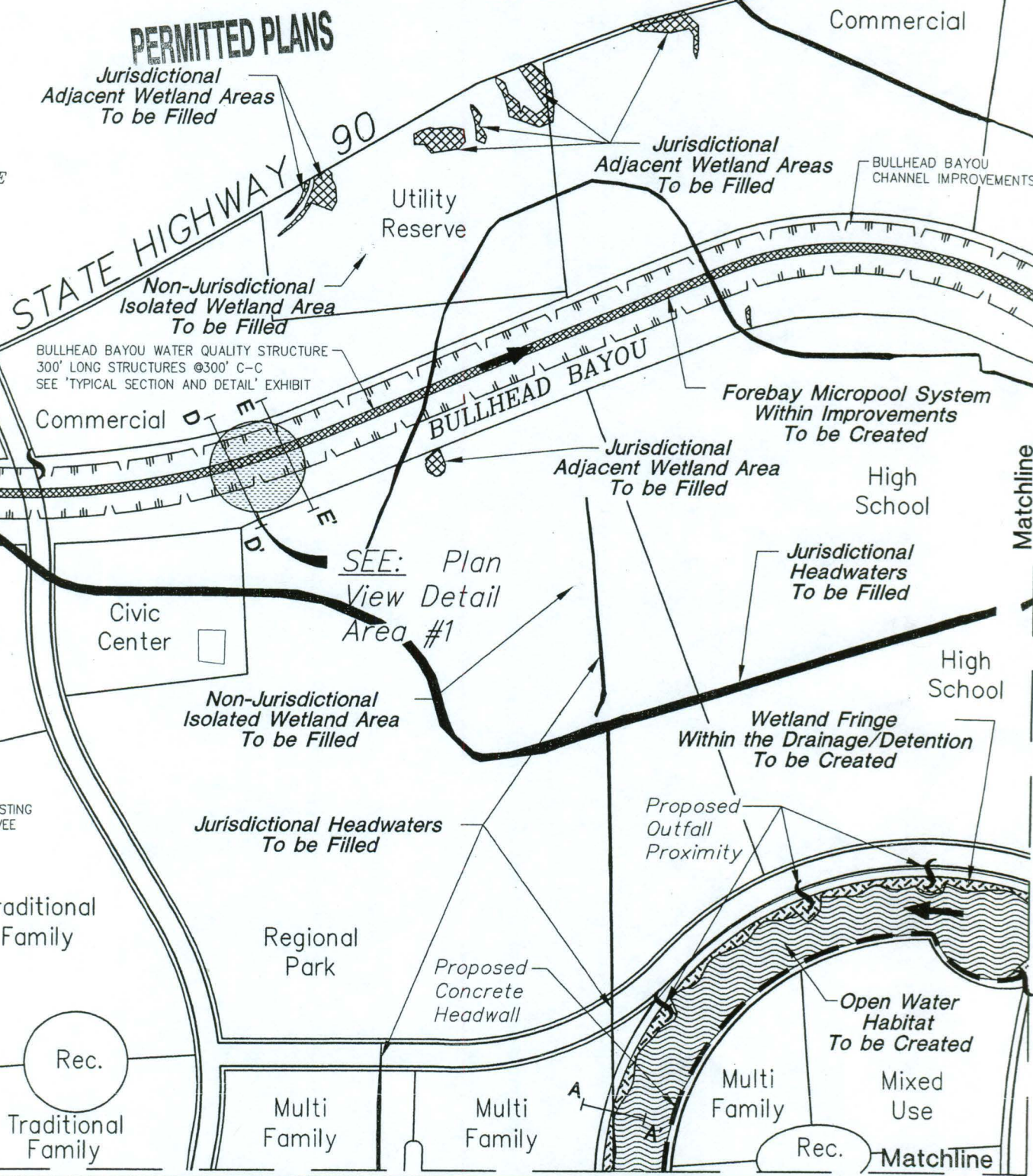
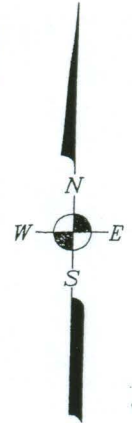
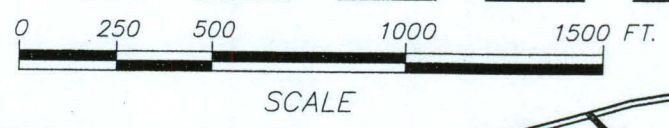

**PROPOSED SITE DEVELOPMENT
WETLAND OVERLAY MAP**

PROJECT #: 4170PM03
FOR: NEWLAND COMMUNITIES
LOCATION: 2018 ACRES - S.H. 6 & S.H. 90
FORT BEND COUNTY, TEXAS

REVISIONS:
Oct. 29, 2003 by C. H. Andrews
Nov. 14, 2003 by C. H. Andrews
Dec. 4, 2003 by E. Boulet
March 15, 2004 by C. H. Andrews

BERG-OLIVER ASSOCIATES, INC.
ENVIRONMENTAL SCIENCE, ENGINEERING &
LAND USE CONSULTANTS
14811 ST. MARY'S LANE, SUITE 263
HOUSTON, TEXAS 77079 PHONE (281) 589-0898



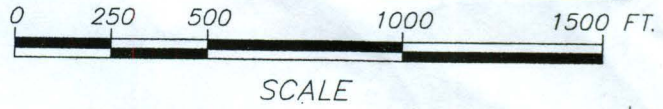

PERMITTED PLANS

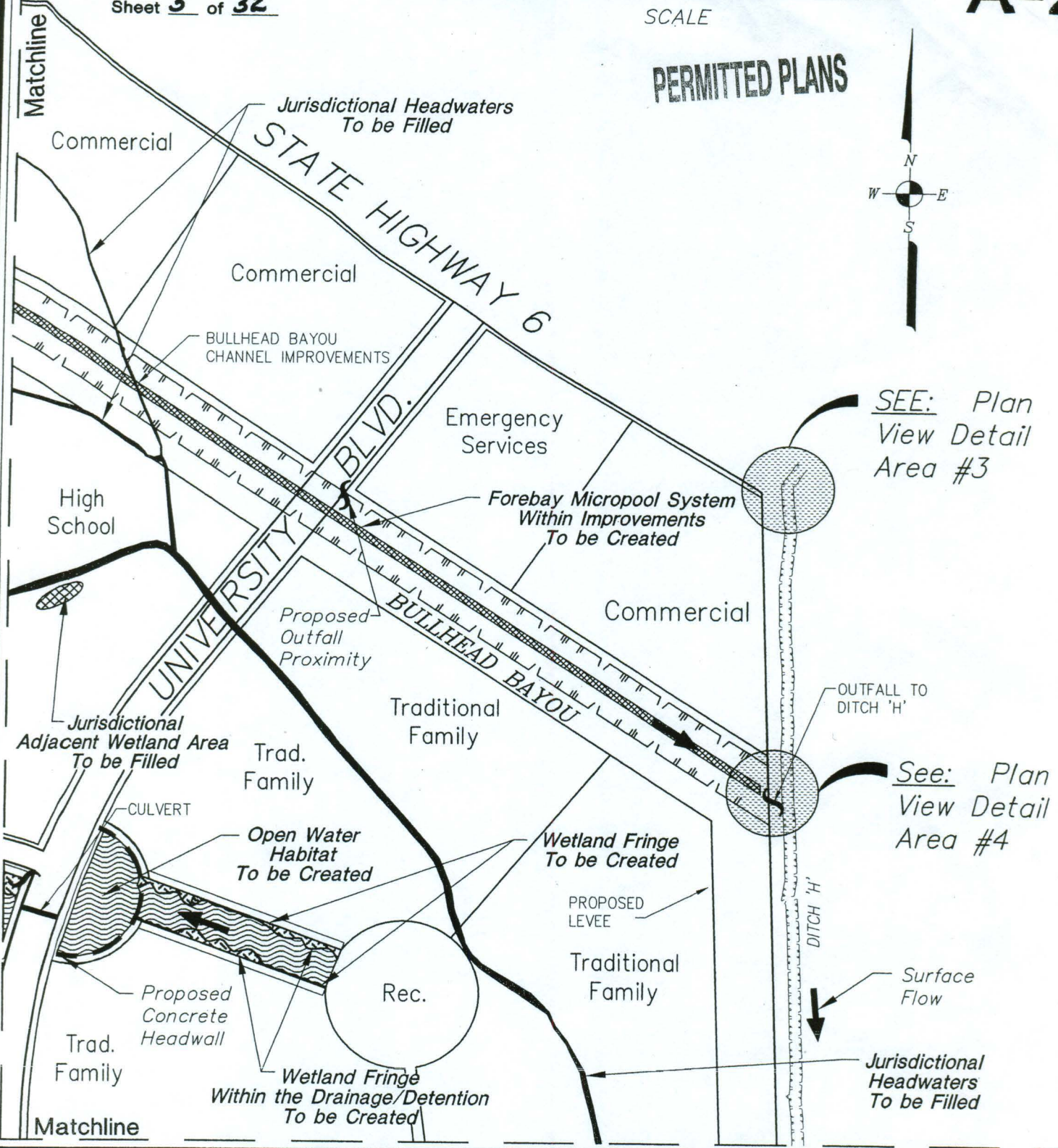
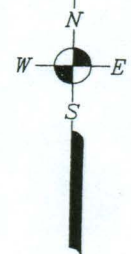

SEE: Plan View Detail Area #3

See: Plan View Detail Area #4

PROPOSED SITE DEVELOPMENT
WETLAND OVERLAY MAP

PROJECT #: 4170PM03
FOR: NEWLAND COMMUNITIES
LOCATION: 2018 ACRES - S.H. 6 & S.H. 90
FORT BEND COUNTY, TEXAS

REVISIONS:
Oct. 29, 2003 by C. H. Andrews
Nov. 14, 2003 by C. H. Andrews
Dec. 4, 2003 by E. Boulet
March 15, 2004 by C. H. Andrews

BERG-OLIVER ASSOCIATES, INC.
ENVIRONMENTAL SCIENCE, ENGINEERING &
LAND USE CONSULTANTS
14701 ST. MARY'S LANE, SUITE 400 HOUSTON, TX 77079
PHONE (281) 589-0898 <http://www.bergoliver.com>



NEWLAND COMMUNITIES
PERMIT #23235
Sheet 4 of 32

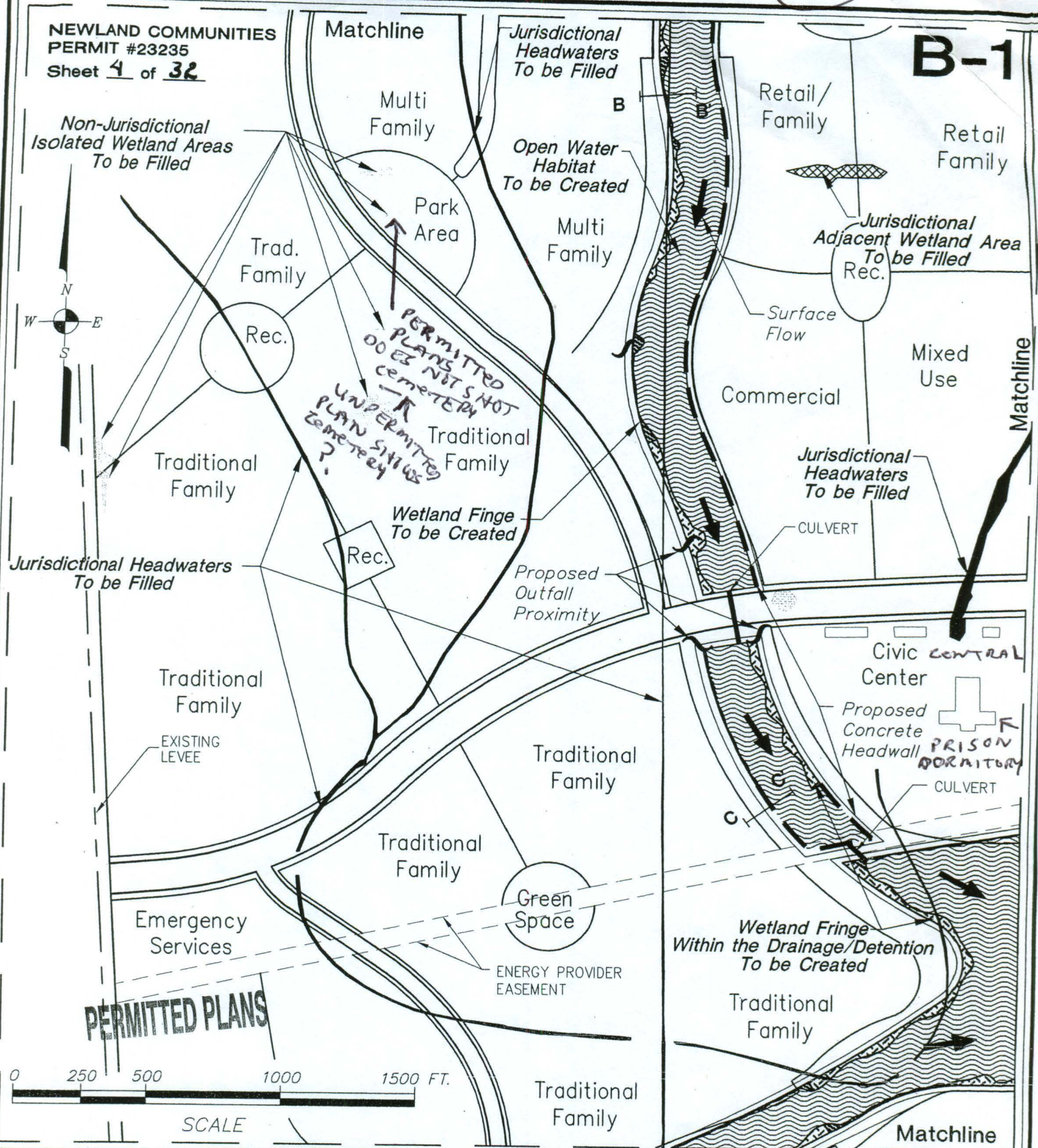

**PROPOSED SITE DEVELOPMENT
WETLAND OVERLAY MAP**

PROJECT #: 4170PM03
FOR: NEWLAND COMMUNITIES
LOCATION: 2018 ACRES - S.H. 6 & S.H. 90
FORT BEND COUNTY, TEXAS

REVISIONS:
Oct. 29, 2003 by C. H. Andrews
Nov. 14, 2003 by C. H. Andrews
Dec. 4, 2003 by E. Boulet
March 16, 2004 by C. H. Andrews

BERG • OLIVER ASSOCIATES, INC.
ENVIRONMENTAL SCIENCE, ENGINEERING &
LAND USE CONSULTANTS
14701 ST. MARY'S LANE, SUITE 400 HOUSTON, TX 77079
PHONE (281) 589-0898 <http://www.bergoliver.com>



38

Sheet _____ of _____

NOV 21 2003

B-1

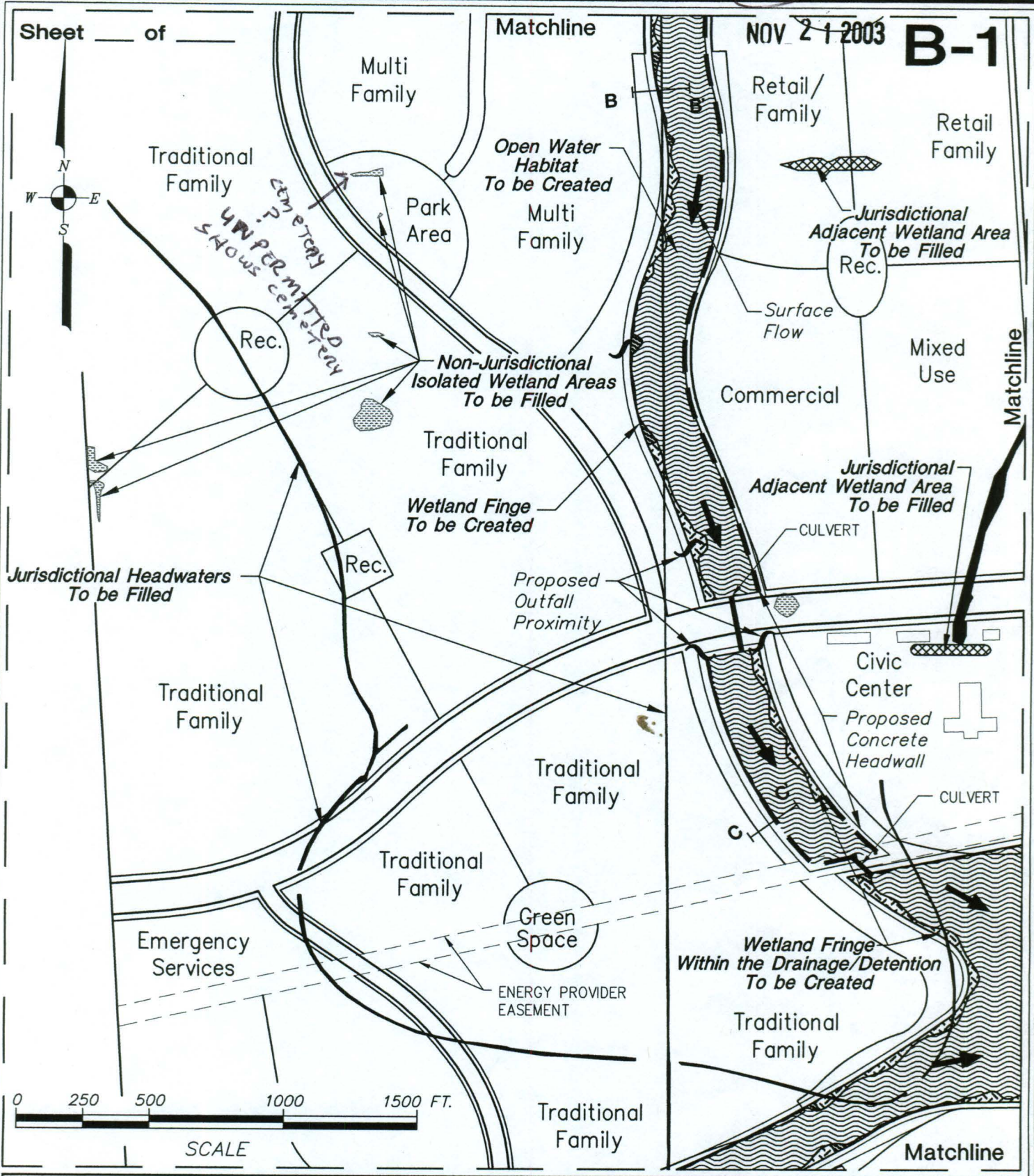

Newland Communities
 23235
 Sheet 8 of 25

**PROPOSED SITE DEVELOPMENT
 WETLAND OVERLAY MAP**

PROJECT #: 4170PM03
 FOR: NEWLAND COMMUNITIES
 LOCATION: 2018 ACRES - S.H. 6 & S.H. 90
 FORT BEND COUNTY, TEXAS

REVISIONS:
Oct. 29, 2003 by C. H. Andrews
Nov. 14, 2003 by C. H. Andrews

BERG•OLIVER ASSOCIATES, INC.
 ENVIRONMENTAL SCIENCE, ENGINEERING &
 LAND USE CONSULTANTS
 14701 ST. MARY'S LANE, SUITE 400 HOUSTON, TX 77079
 PHONE (281) 589-0898 <http://www.bergoliver.com>



NEWLAND COMMUNITIES
PERMIT #23235
Sheet 5 of 32

B-2

PERMITTED PLANS

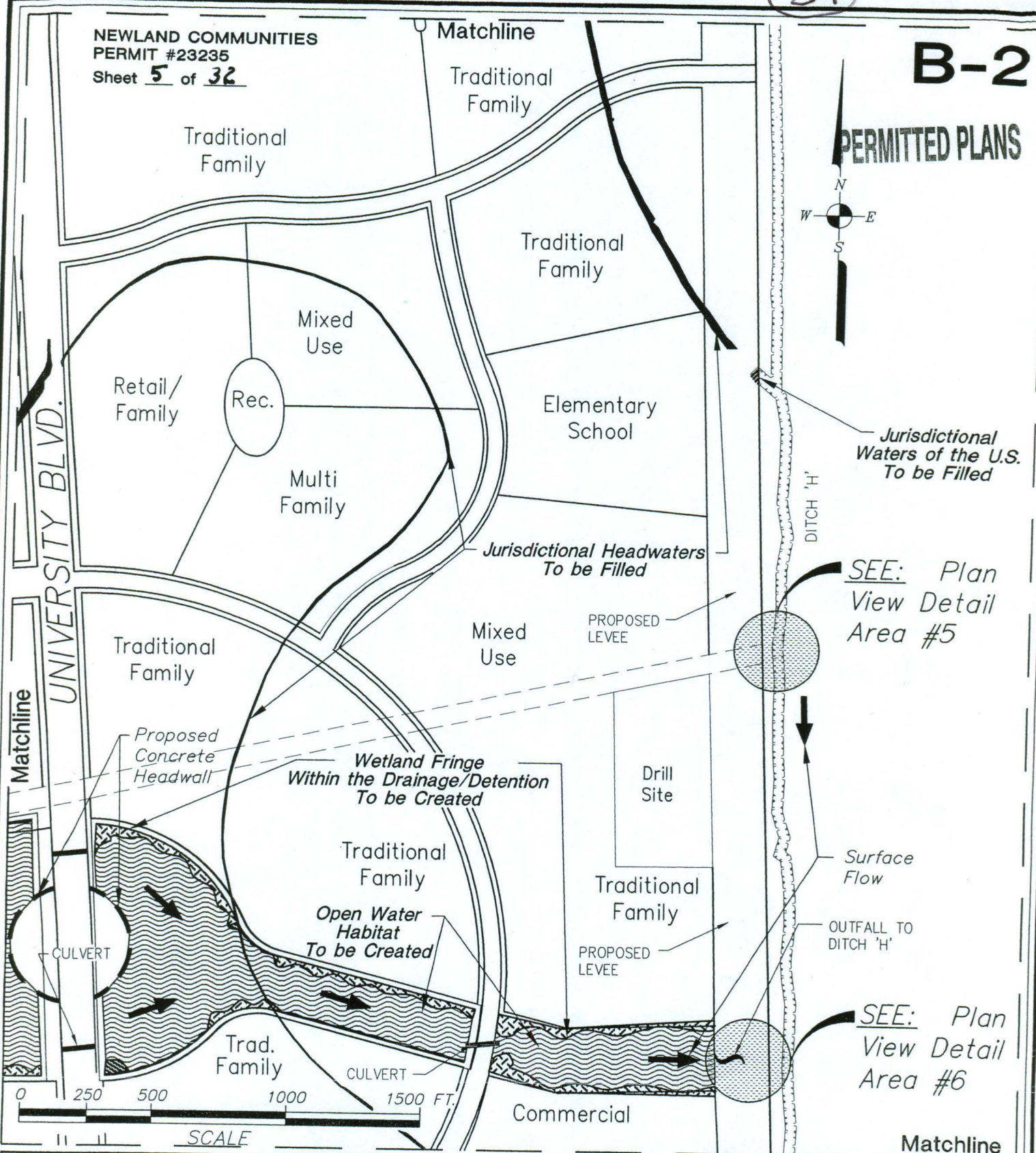

PROPOSED SITE DEVELOPMENT
WETLAND OVERLAY MAP

PROJECT #: 4170PM03
FOR: NEWLAND COMMUNITIES
LOCATION: 2018 ACRES - S.H. 6 & S.H. 90
FORT BEND COUNTY, TEXAS

REVISIONS:
Oct. 29, 2003 by C. H. Andrews
Nov. 14, 2003 by C. H. Andrews
Dec. 4, 2003 by E. Boulet
March 16, 2004 by C. H. Andrews

BERG • OLIVER ASSOCIATES, INC.
ENVIRONMENTAL SCIENCE, ENGINEERING &
LAND USE CONSULTANTS
14701 ST. MARY'S LANE, SUITE 400 HOUSTON, TX 77079
PHONE (281) 589-0898 <http://www.bergoliver.com>



NEWLAND COMMUNITIES
PERMIT #23235
Sheet 6 of 32

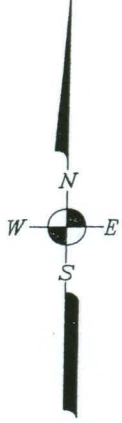

Traditional Family

EXISTING LEVEE

Proposed
Outfall
Proximity

Rec.

Proposed
Concrete
Headwall

Jurisdictional Headwaters
To be Filled

Traditional Family

Wetland Fringe
Within the Drainage/Detention
To be Created

EXISTING LEVEE

Traditional Family

Traditional Family

PERMITTED PLANS

Commercial

Open Water
Habitat
To be Created

Jurisdictional Headwaters
To be Filled

Amenity
Lakes
To be Created

Traditional Family

U. S. HIGHWAY 59

Forebay Micropool System
Within Improvements
To be Created

Lake Estate Residential



Matchline

PROPOSED SITE DEVELOPMENT
WETLAND OVERLAY MAP

PROJECT #: 4170PM03
FOR: NEWLAND COMMUNITIES
LOCATION: 2018 ACRES - S.H. 6 & S.H. 90
FORT BEND COUNTY, TEXAS

REVISIONS:
Oct. 29, 2003 by C. H. Andrews
Nov. 14, 2003 by C. H. Andrews
Dec. 4, 2003 by E. Boulet
March 17, 2004 by C. H. Andrews

BERG • OLIVER ASSOCIATES, INC.
ENVIRONMENTAL SCIENCE, ENGINEERING &
LAND USE CONSULTANTS
14701 ST. MARY'S LANE, SUITE 400 HOUSTON, TX 77079
PHONE (281) 589-0898 <http://www.bergoliver.com>



41

NEWLAND COMMUNITIES
PERMIT #23235
Sheet 7 of 32

C-2

TRACT 4

SEE: Plan View Detail Area #7

TRACT 5

Matchline

PROPOSED LEVEE

Commercial

Traditional Family

Jurisdictional Headwaters To be Filled

PERMITTED PLANS
Commercial

Commercial

U. S. HIGHWAY 59

Commercial

PROPOSED LEVEE

Office Park

Jurisdictional Headwaters To be Filled

Multi Family

Matchline

Matchline

0 250 500 1000 1500 FT.

SCALE

PROPOSED SITE DEVELOPMENT
WETLAND OVERLAY MAP

PROJECT #: 4170PM03
FOR: NEWLAND COMMUNITIES
LOCATION: 2018 ACRES - S.H. 6 & S.H. 90
FORT BEND COUNTY, TEXAS

REVISIONS:
Oct. 29, 2003 by C. H. Andrews
Nov. 14, 2003 by C. H. Andrews
Dec. 4, 2003 by E. Boulet
March 17, 2004 by C. H. Andrews

BERG • OLIVER ASSOCIATES, INC.
ENVIRONMENTAL SCIENCE, ENGINEERING &
LAND USE CONSULTANTS
14701 ST. MARY'S LANE, SUITE 400 HOUSTON, TX 77079
PHONE (281) 589-0898 <http://www.bergoliver.com>



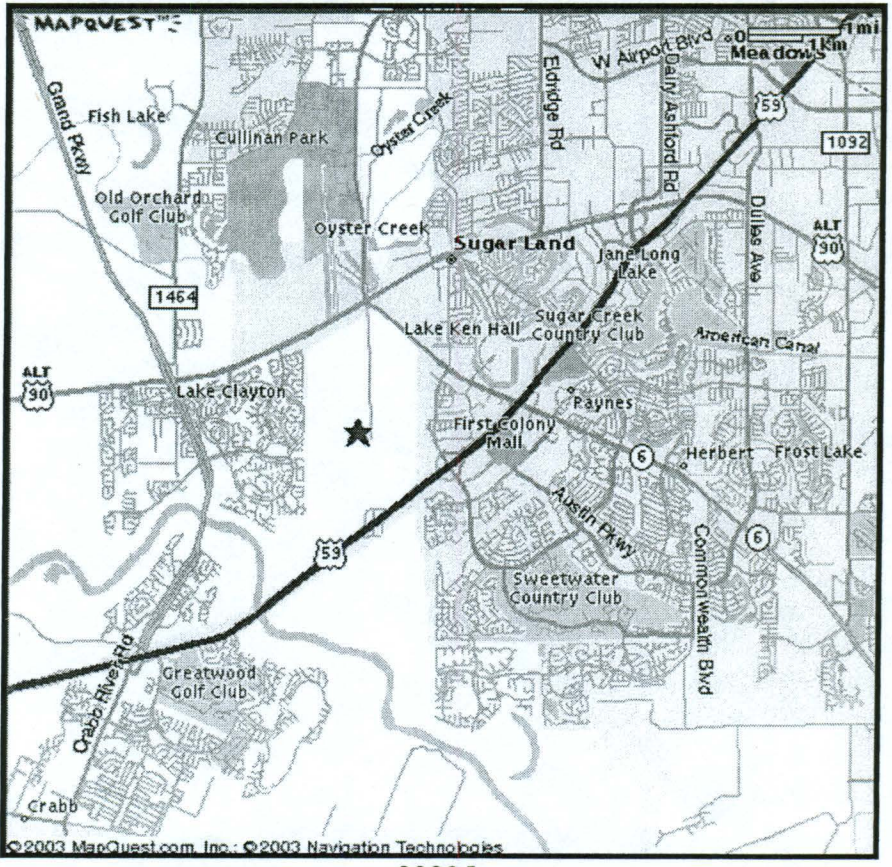
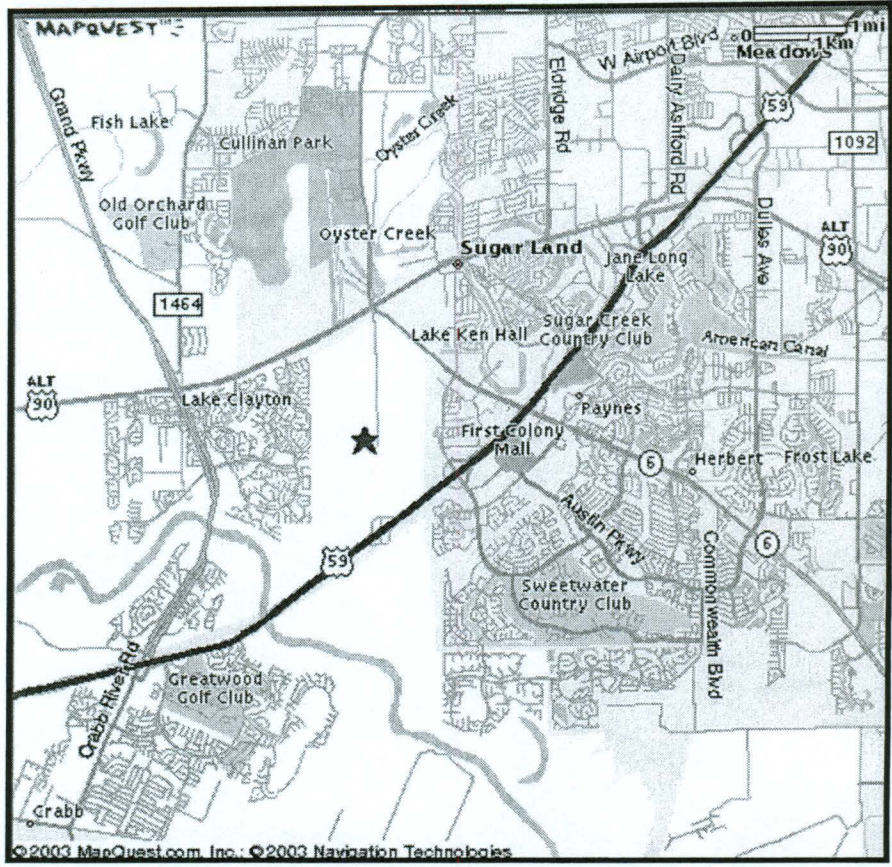

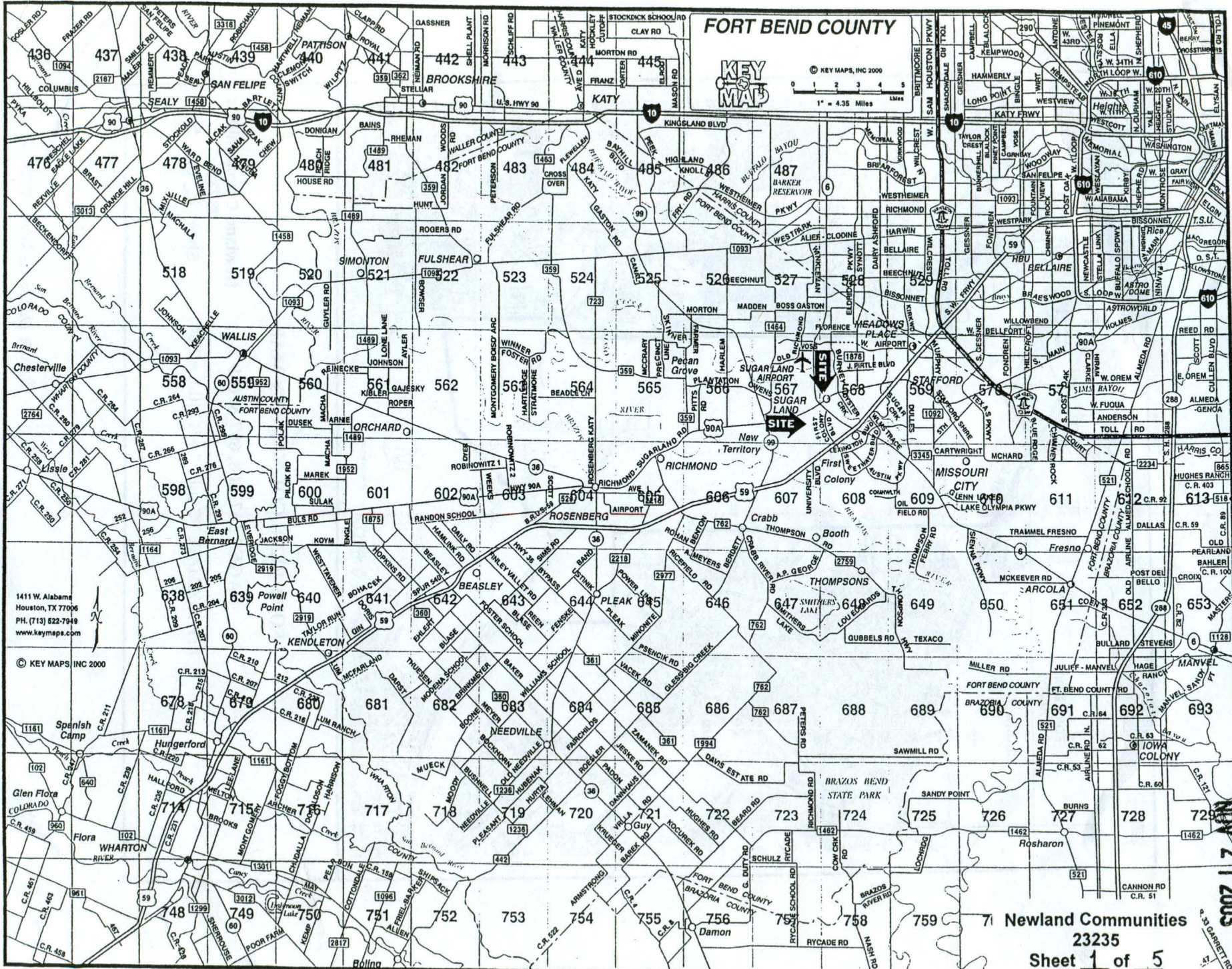

FORT BEND COUNTY



© KEY MAPS, INC 2000
 0 1 2 3 4 5
 1" = 4.35 Miles
 LINES

1411 W. Alabama
 Houston, TX 77006
 PH. (713) 822-7949
 www.keymaps.com

© KEY MAPS, INC 2000

Newland Communities
 23235
 Sheet 1 of 5

NOV 21 2003

43

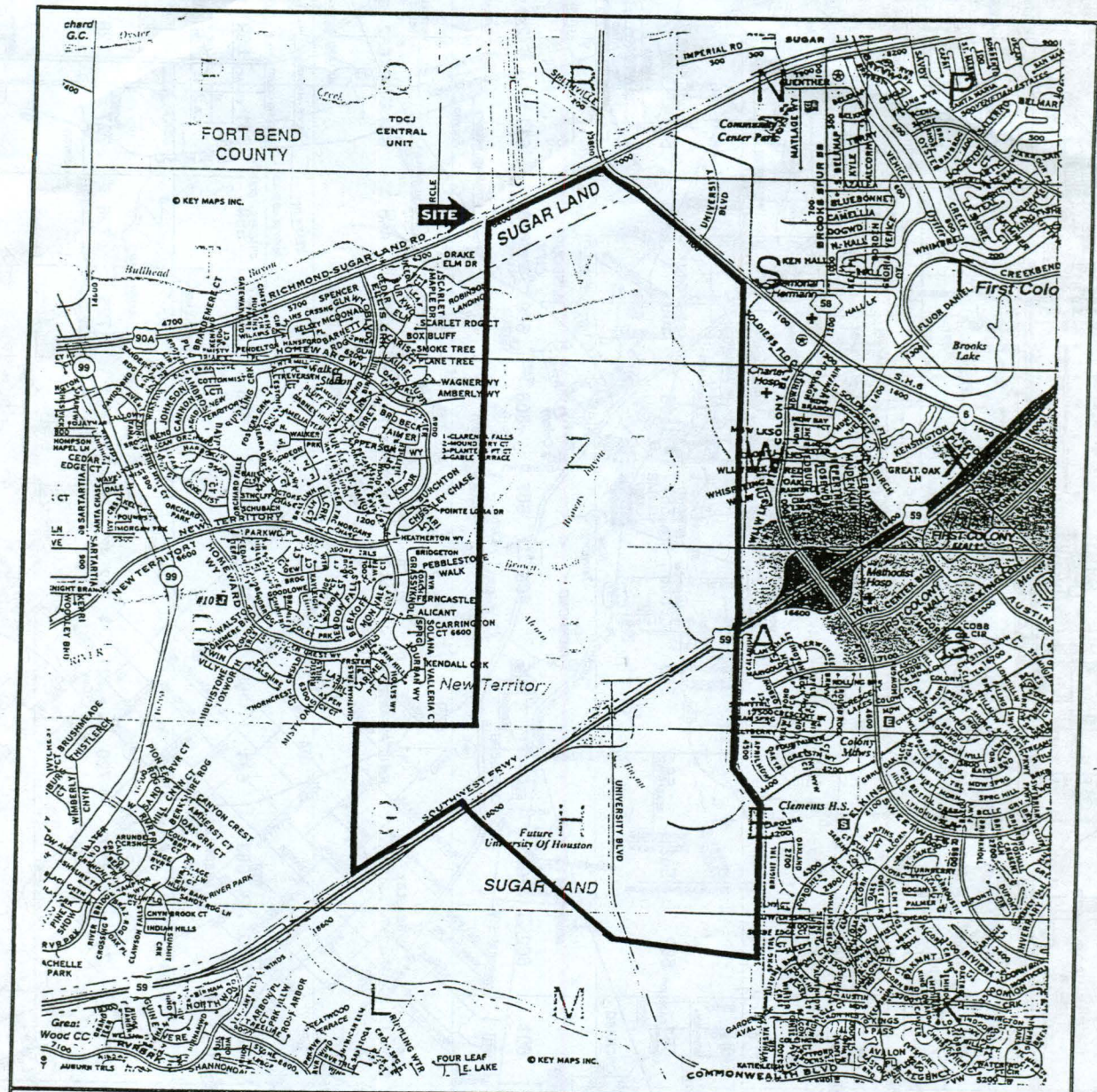

FORT BEND COUNTY KEY MAP

PAGES 567, 568, 607 & 609

APPROXIMATE SCALE 1" = 1/2 MILE = 2,640'

Newland Communities

23235

Sheet 2 of 5